

过渡接头 ADAPTER

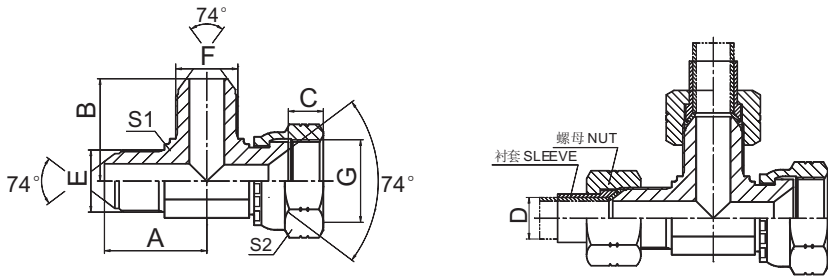

CJ

美制 JIC 外螺纹 / 美制 JIC 外螺纹 / 美制 JIC 内螺纹
JIC MALE/JIC MALE/JIC FEMALE

代号 PART NO.	螺纹 THREAD			尺寸 DIMENSIONS					
	E	F	G		A	B	C	S1	S2
CJ-04	7/16"X20	7/16"X20	7/16"X20		24.5	24.5	9	11	15
CJ-05	1/2"X20	1/2"X20	1/2"X20		26.6	26.6	9.5	14	17
CJ-06	9/16"X18	9/16"X18	9/16"X18		26.9	26.9	10.5	14	19
CJ-08	3/4"X16	3/4"X16	3/4"X16		32	32	9.5	19	24
CJ-10	7/8"X14	7/8"X14	7/8"X14		37.8	37.8	13	22	27
CJ-10-08-10	7/8"X14	7/8"X14	7/8"X14		37.8	34.8	13	22	27
CJ-12	1.1/16"X12	1.1/16"X12	1.1/16"X12		44.2	44.2	15	27	32
CJ-12-08-12	1.1/16"X12	1.1/16"X12	1.1/16"X12		44.2	37.9	15	27	32
CJ-14	1.3/16"X12	1.3/16"X12	1.3/16"X12		47.5	47.5	15	30	36
CJ-16	1.5/16"X12	1.5/16"X12	1.5/16"X12		49	49	16	33	41
CJ-20	1.5/8"X12	1.5/8"X12	1.5/8"X12		55.5	55.5	17	41	50
CJ-24	1.7/8"X12	1.7/8"X12	1.7/8"X12		63	63	20	48	55
CJ-32	2.1/2"X12	2.1/2"X12	2.1/2"X12		78	78	24.5	63	75

注：螺母及衬套需另行订货。管子直径 D 为公制时，配用螺母及衬套分别选用 NB200、NB500。管子直径为英制时，配用螺母及衬套分别选用 NB200、NB300。 Nut and sleeve should be ordered separately. The nut NB200 and sleeve NB500 is suitable for metric tube, the nut NB200 and sleeve NB300 is suitable for inch tube.